

FDMS—TP

Fitting Instruction

T-Bar Meeting Stile Seal

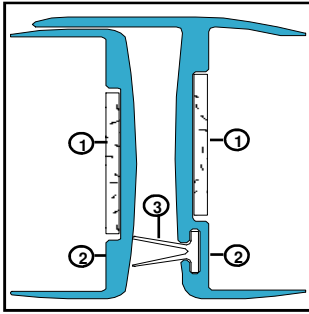

Length:

DESCRIPTION OF CONTENTS

- Intumescent strip (1)
- Aluminium carrier (2)
- Silicone gasket (3)
- Bag of screws
- Fitting instructions

TOOLS REQUIRED FOR INSTALLATION

- Tape Measure
- Saw (Power or Hand)
- Screw Driver
- Drill (Power or Hand)
- 4.5mm Drill Bit
- 2.5mm Drill Bit
- Knife
- Pencil or marker

INSTALLATION DETAIL

It is not necessary to remove the door from its hinges unless otherwise specified.

STEP 1

Remove the seal from the packaging and measure the meeting edges of the door leaves to determine the seal lengths required.

STEP 2

Pull back the silicone gasket and cut the aluminium meeting stiles to length. Slide the gasket back into position and cut to length.

STEP 3

Measure and mark the fixing hole location on stiles. Holes are located on the centre-line of the stiles 50mm down from the top, 50mm from the bottom & at the lock height, avoiding strike and lock plates. **(this corresponds with the doors internal reinforcing plates and ensures a good fixing).**

STEP 4

Drill 4.5mm clearance holes for the fixing screws and countersink so that the screw heads are slightly recessed under the surface of both meeting stiles.

STEP 5

Select the inactive leaf and position the flanged meeting stile over the door edge ensuring that the stop is on the correct side and that it is flush top and bottom.

STEP 6

With a pencil mark through the fixing holes, remove meeting stile and drill 2.5mm pilot holes through the door lipping and internal steel reinforcing plates.

STEP 7

Measure, mark and cut out holes / apertures for lock set and striker plates.

STEP 8

Re-position meeting stile and screw fix in place.

STEP 9

For fixing of the plain stile, repeat steps 2 to 8.

STEP 10

Check doors operate correctly and that the latch engages in strike.

IMPORTANT

Ensure that the installation of this product does not impede the self closing and self latching of the door. Periodic inspection and cleaning is recommended to fully maintain this sealing system.



NOTE

Recommendations as to methods for use of materials and construction details are based on the experience and knowledge of Lorient and are given in good faith as a general guide and service to designers, contractors and manufacturers.

Lorient reserves the right to make alterations or delete any installation detail without prior notice.

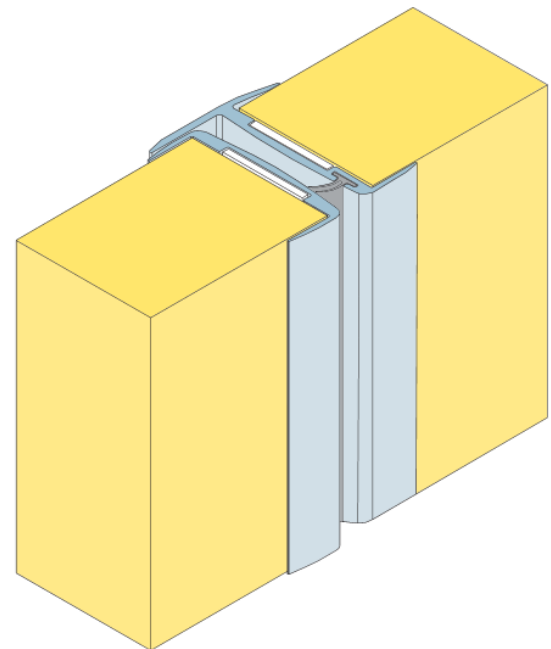

OTHER LORIENT ARCHITECTURAL SEALS INCLUDE: INTEGRITY™ RANGE

- | | |
|-------------------------------|--------------------|
| ■ Door Perimeter Seals | ■ Threshold Plates |
| ■ Door Bottom Seals | ■ Brush Seals |
| ■ Automatic Door Bottom Seals | ■ Magnetic Seals |

Contact your nearest Lorient office for further details.

AUSTRALIA
Lorient Australia
Tel 1300 858 010

ASIA PACIFIC
Lorient Pacific Limited Hong Kong
Tel: (+852) 2505 0328

EUROPE
Lorient Polyproducts Ltd UK
Tel: (+44) 1626 834252

MIDDLE EAST
Lorient Middle East Building
Materials Trading LLC Dubai

Tel (+971) 4267 4339
Fax (+971) 4267 5339

