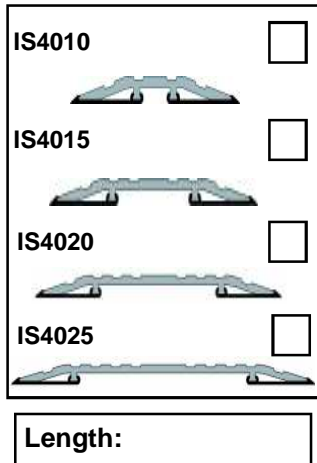

**IS4010, IS4015,
IS4020, IS4025
Fitting Instruction****Threshold Plates****DESCRIPTION
OF CONTENTS**

- Aluminium threshold
- Screws and plugs
- Vinyl feet
- Fitting instruction

**TOOLS REQUIRED
FOR INSTALLATION**

- Tape measure
- Pencil or marker
- Saw (power or hand)
- Power drill
- 3mm drill bit
- 6mm masonry bit
- Countersink
- Construction adhesive

INSTALLATION DETAIL**STEP 1**

Remove the plate from the packaging and measure the door width, between jambs or door stops to determine the plate length required.

STEP 2

Measure the threshold plate and mark the desired length (and profile if cutting around door stop) with a pencil

STEP 3

Pull back vinyl feet and cut the threshold plate to length using a saw. Trim vinyl bedding feet to length with knife

STEP 4

Position the plate on the door sill in required location.

STEP 5**Screw Fix**

Using a power drill with a 3mm drill bit, create fixing holes in required position, making sure to countersink.

Offer seal to threshold and mark hold centres on floor.

Using masonry drill, create fixing holes. Clean away dust and insert supplied plastic plugs

Screw fix the threshold in place using screws & plugs supplied

Adhesive Fix

Apply adhesive to the back of the threshold plate and place it in the desired position.

Note: for exterior applications
Where threshold plate meets the door stop, sealant should be applied to prevent water ingress).

STEP 6

Check to ensure the door opens and closes freely.

NOTE

For effective operation, the IS4010, IS4015, IS4020, IS4025 threshold plates require a minimum of 8mm clearance between the door and the floor.

IMPORTANT – Ensure that the installation of this product does not impede the opening or closing of the door.

**OTHER INTEGRITY™
ARCHITECTURAL SEALS
INCLUDE:**

- Door Perimeter Seals
- Door Bottom Seals
- Automatic Door Bottom Seals
- Threshold Plates
- Brush Seals
- Magnetic Seals

Contact your nearest Lorient office for further details.

NOTE

Recommendations as to methods for use of materials and construction details are based on the experience and knowledge of Lorient and are given in good faith as a general guide and service to designers, contractors and manufacturers.

Lorient reserves the right to make alterations or delete any installation detail without prior notice.

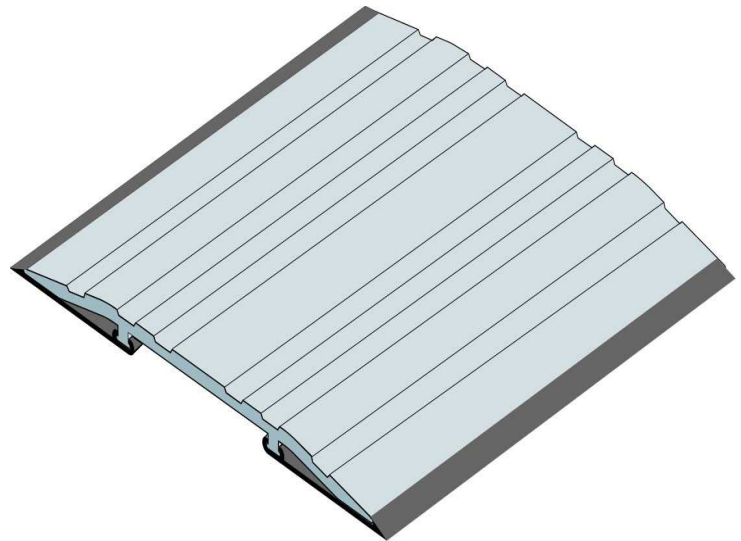

AUSTRALIA
Lorient Australia
Tel 1300 858 010

ASIA PACIFIC
Lorient Pacific Limited Hong Kong
Tel: (+852) 2505 0328

EUROPE
Lorient Polyproducts Ltd UK
Tel: (+44) 1626 834252

MIDDLE EAST
Lorient Middle East Building
Materials Trading LLC Dubai
Tel (+971) 4267 4339
Fax (+971) 4267 5339