

**PRODUCT CODE**
**IS4110, IS4120, IS4130**
**DESCRIPTION**

Medium duty, low profile threshold plates.

**APPLICATION**

These threshold plates are used in conjunction with other Lorient Integrity™ seals to prevent rain, draught and smoke penetration. Their low profile ensures compliance with the 'access for people with disability' requirements, particularly for wheelchair traffic.

**KEY FEATURES**

- Durable, anodised, aesthetic finish.
- Low profile design, complying with AS1428/1 and BCA D3.
- Suitable for wheelchair traffic.
- Helps prevent rain infiltration when used in conjunction with a Lorient Integrity™ 3000 or 8000 series door bottom seal.

**USE WITH**

Used in conjunction with a Lorient Integrity™ 7000 series perimeter seal and 8000 series automatic door bottom seal to provide a total door sealing solution.

**MATERIALS**

Extruded and anodised aluminium.

**SIZES**

**Standard Lengths**      1000mm, 2250mm  
**Also available in**      250mm increments: 1000mm to 5000mm

**FINISH**

- Silver anodised aluminium.
- Bronze anodised aluminium.

**FIXING**

Fixing screws are supplied.

**APPROVAL/S**

- AS1530/4 fire tests with proprietary fire door assemblies.
- Complies with AS1428/1 (Design for access and mobility).
- Conforms to Building Code of Australia BCA D3 (Access for people with disabilities).

**SPECIFICATIONS**

Lorient Integrity™ IS4110/IS4120/IS4130 fitted to the threshold under the door.

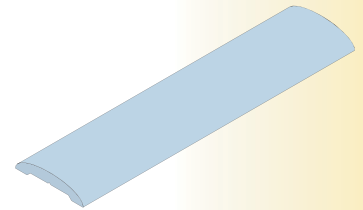
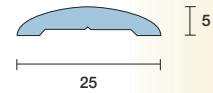
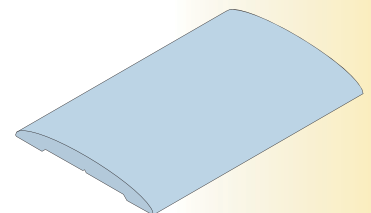
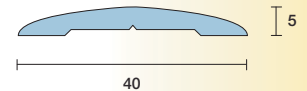
**IS4110**

**IS4120**

**IS4130**
