

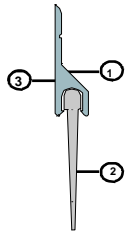

IS5111si, IS5116si, IS5121si,
Fitting Instruction
Silicone Rubber Fin Seals



IS5111si □

IS5116si □

IS5121si □

Length	
--------	--

DESCRIPTION OF CONTENTS

- Aluminium carrier (1)
- Silicone Rubber Fin (2)
- Self-adhesive tape (3)
- Bag of screws
- Fitting instructions

TOOLS REQUIRED FOR INSTALLATION

- Tape measure
- Saw (power or hand)
- Screw driver
- 2.5mm drill bit
- Drill (power or hand)
- Combination pliers
- Pencil or marker

MEETING STILE INSTALLATION DETAIL

It is not necessary to remove the door unless otherwise specified.

STEP 1

Remove the seal from the packaging and measure the lengths of head and jambs.

STEP 2

Cut the aluminium carrier to the lengths required using a saw.

STEP 3

Position the seals to the meeting stile of the door and mark out the slotted hole locations with a pencil.

STEP 4

Drill pilot holes with a 2.5mm drill bit (if required).

STEP 5

Lightly screw-fix with the screws supplied.

STEP 6

Close the door and check for a uniform seal.

PERIMETER INSTALLATION DETAIL

It is not

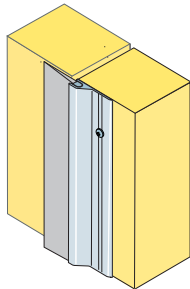

necessary to remove the door unless otherwise specified.

STEP 1

Remove the seal from the packaging and measure the existing head (top) and jambs (sides) of the door frame to determine the seal lengths required.

STEP 2

Cut the aluminium carrier to the lengths required using a saw.

STEP 3

Position the seals to the perimeter of the door and mark out the slotted hole locations with a pencil.

STEP 4

Drill pilot holes with a 2.5mm drill bit (if required).

STEP 5

Lightly screw-fix with the screws supplied.

STEP 6

Close the door and check for a uniform seal.

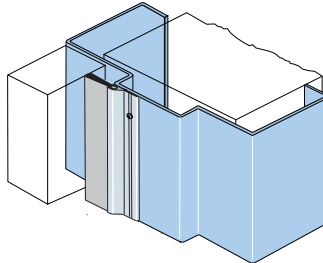

DOOR BOTTOM INSTALLATION DETAIL

It is not necessary to remove the door unless otherwise specified.

STEP 1

Remove the seal from the packaging and measure the bottom of the door to determine the seal length required.

STEP 2

Cut the aluminium carrier to the lengths required using a saw.

STEP 3

Position the seal to the bottom of the door and mark out the slotted hole locations with a pencil.

STEP 4

Drill pilot holes with a 2.5mm drill bit (if required).

STEP 5

Lightly screw-fix with the screws supplied.

STEP 6

Close the door and check for a uniform seal.

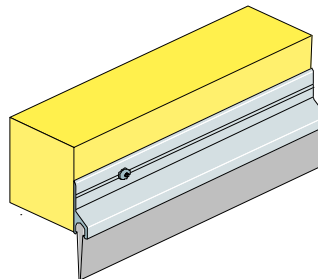

OTHER INTEGRITY™ ARCHITECTURAL SEALS INCLUDE:

- Door perimeter seals
- Door bottom seals
- Automatic door bottom seals
- Threshold plates
- Brush seals
- Magnetic seals

Contact your nearest Lorient office for further details.

Note

Recommendations as to methods for use of materials and construction details are based on the experience and knowledge of Lorient and are given in good faith as a general guide and service to designers, contractors and manufacturers.

Lorient reserves the right to make alterations or delete any installation detail without prior notice.

IMPORTANT – *Ensure that the installation of this product does not impede the opening or closing of the door. It is recommended to check the adjustment of the door seal periodically to ensure the door assembly to which it is fitted, closes and latches properly.*

Fixing Note: *In many situations the self-adhesive tape will be sufficient to hold the seal in place, provided the surface is clean, smooth and dry. For added security, it is recommended to use the screw fixings.*

AUSTRALIA
Lorient Australia
Tel 1300 858 010

ASIA PACIFIC
Lorient Pacific Limited Hong Kong
Tel: (+852) 2505 0328

EUROPE
Lorient Polyproducts Ltd UK
Tel: (+44) 1626 834252

MIDDLE EAST
Lorient Middle East Building Materials Trading LLC Dubai
Tel (+971) 4267 4339
Fax (+971) 4267 5339

