

WALL 7

FIRE RATED CSR HEBEL® WALL SYSTEM

DESCRIPTION

- 1 CSR Hebel® wall with prepared aperture.
- 2 0.6mm (min) Z275 galvanised steel angles to all four sides. Angle dimensions shall be continuous and at least 2 x the dimension of the gap between the damper casing and the penetrated element.
- 3 Each angle fixed to damper casing with steel fasteners at 150mm centres or at least 2 per side.
- 4 Z275 galvanised steel casing minimum thickness 0.6mm.
- 5 Lorient LVH44 intumescent fire damper screw fixed into casing.
- 6 Casing terminates with breakaway joints, as per AS1682.2
- 7 Fire damper perimeter sealed with Lorient intumescent sealant.
- 8 LVH44 fixed to casing with steel screws.
- 9 Gap between casing and aperture filled with Lorient intumescent sealant. Backing rod used as required to control sealant fill depth. Maximum annular gap between casing and wall 25mm.

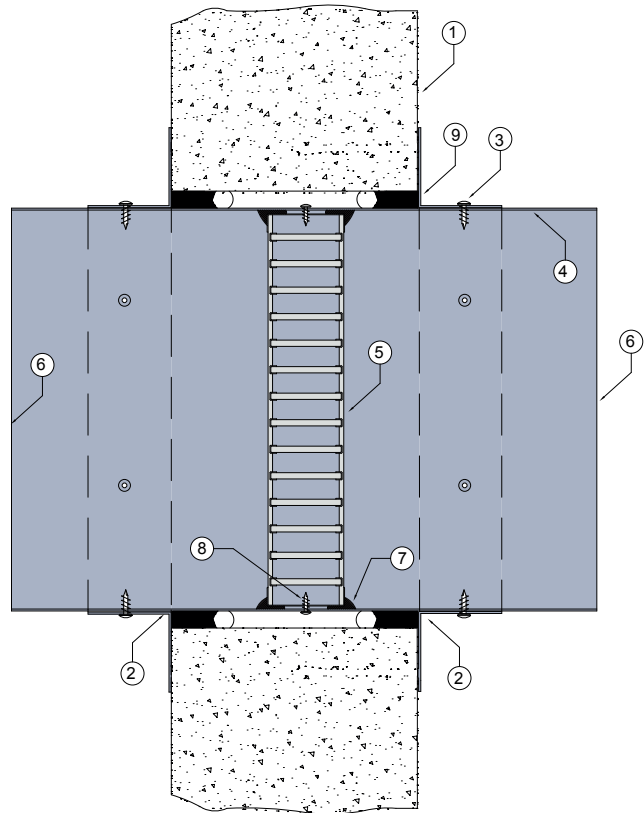

**LVH44 in steel casing
penetrating fire rated
CSR Hebel® wall**

FRL Up to -/120/60

**Fire Resistance in
accordance with**

AS1530.4 2014

Approval Ref

EXOVA EWFA 33233400

Max single cell size

450mm x 450mm

INSTALLATION INSTRUCTIONS

- Prepare the wall opening to accept the fire damper and install in wall, as shown in system detail.
- Centralise the casing and firestop the gap between the casing and wall with Lorient intumescent sealant, note fill details in point 9.
- Perimeter angles are mechanically fixed to casing with steel self drilling screws or pop rivets, as detailed in points 2 & 3.
- Ductwork shall be connected with breakaway joints, as per point 6.
- Ensure product identification labels are conspicuously positioned for easy identification.
- Ensure convenient access is provided to allow for AS1851 inspection and maintenance routines.

► **Note: Damper casings, angles and fixings supplied by others.**